

Capital Projects Update

July 31, 2025

Lisa Coleman, Director of Engineering

Madison Metropolitan Sewerage District



Preview

Overview of Projects in Planning/Design/Construction

- 2025: projects completed + bids to date
- Project highlights



Planning

Treatment Plant

- Heat and Power Improvements (Facility Plan)
- Biosolids Facility Plan

Interceptors

- WI Rehab- Babcock to Dayton Street (C2027)
- WI Rehab-Farley to Marshall (C2027)
- West Interceptor on Regent St (Park to E. Campus Mall) (C2028)
- NEI – Truax Extension Rehab

Pumping Stations & Force Mains

- Crosstown Force Main Air Release Valve Saddle Tap Replacements (C2026)

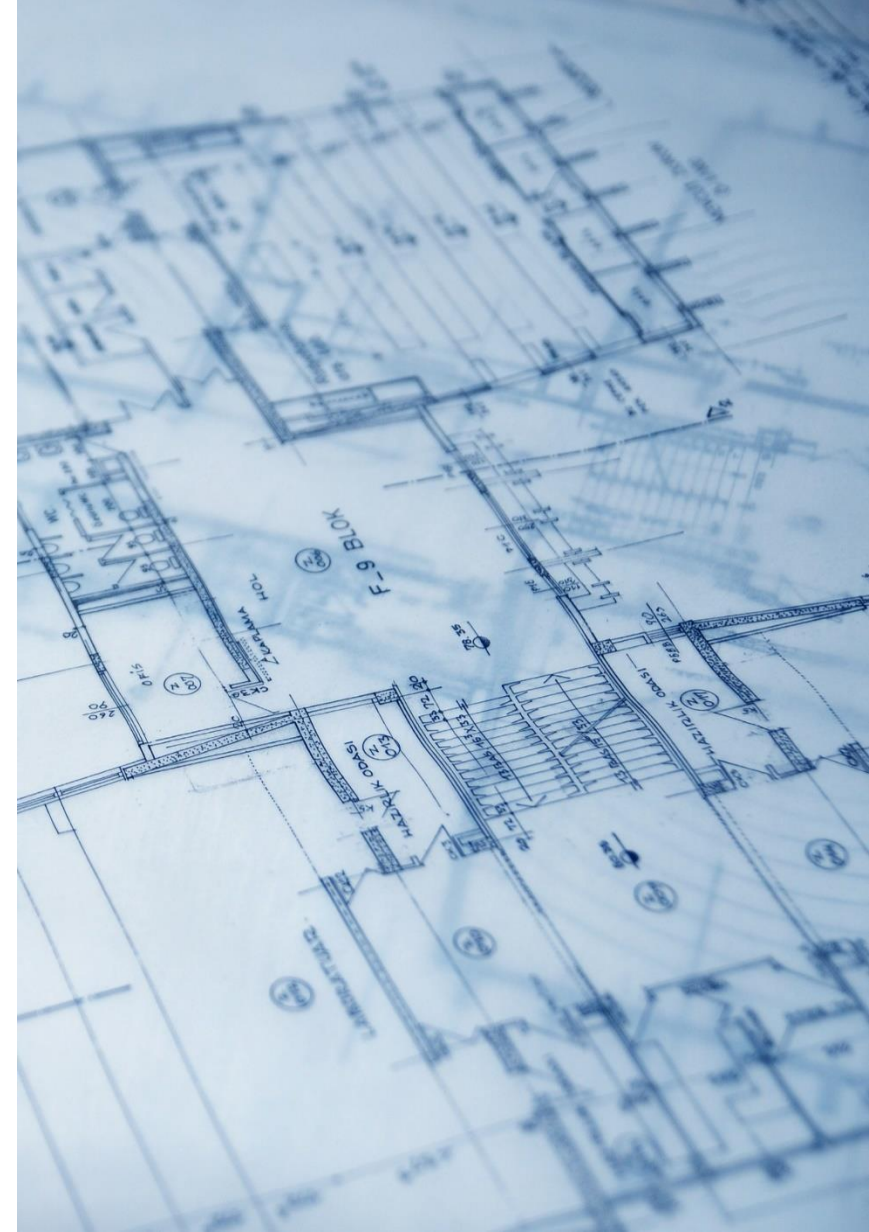

In design

Treatment Plant

- Liquid Processing Phase 2 (bundled...)
- Lagoon Dike Improvements
- Dryer and Seeding Modifications
- W4 System Improvements

Interceptors

- Manhole Rehabilitation on Old West Interceptor
- NSVI Capacity Improvements (Phase 1)
- NSVI Capacity Improvements (Phase 2)
- Southeast Interceptor Relocation at Yahara River

Pumping Stations & Force Mains

- Pumping Station Bar Screens

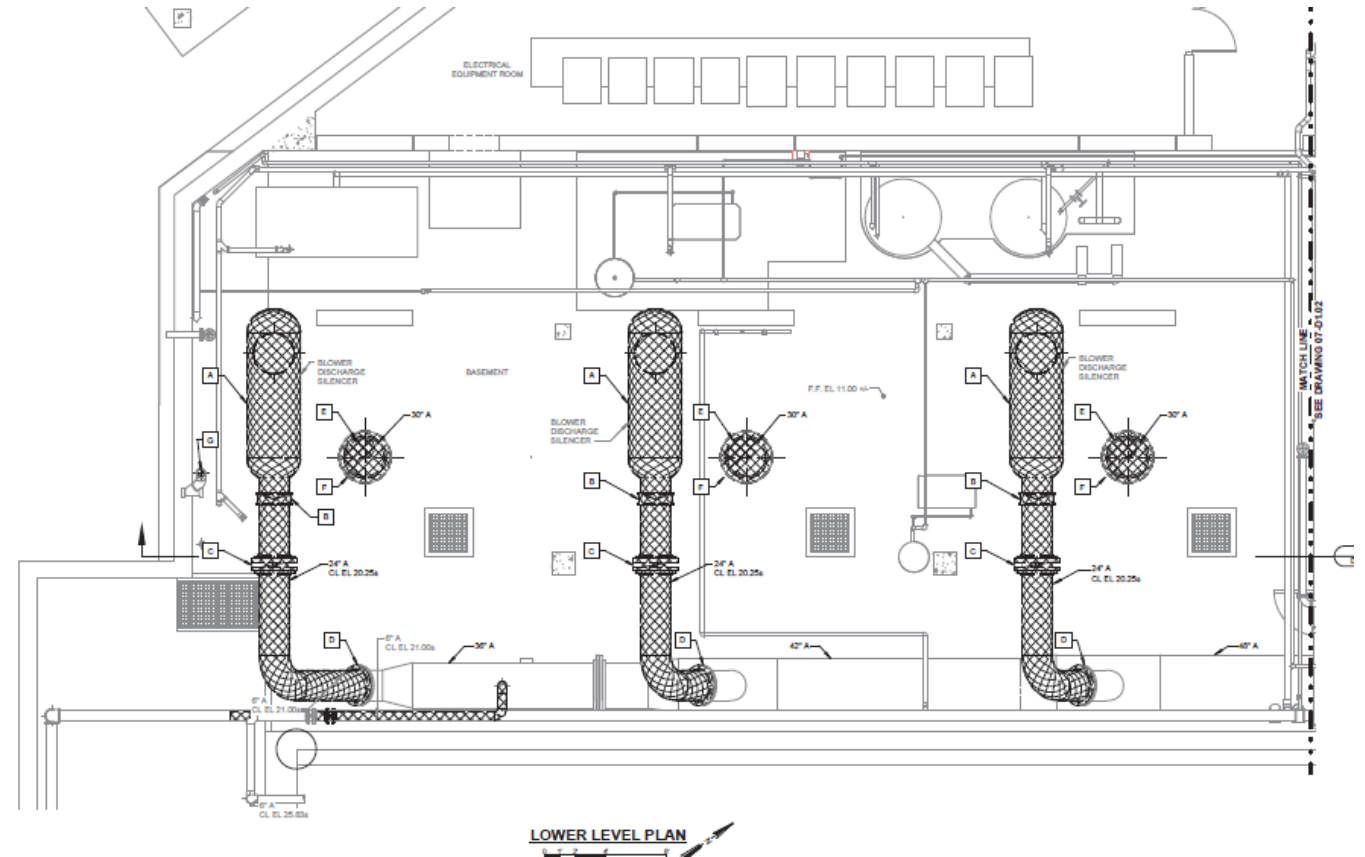

Current Construction Projects

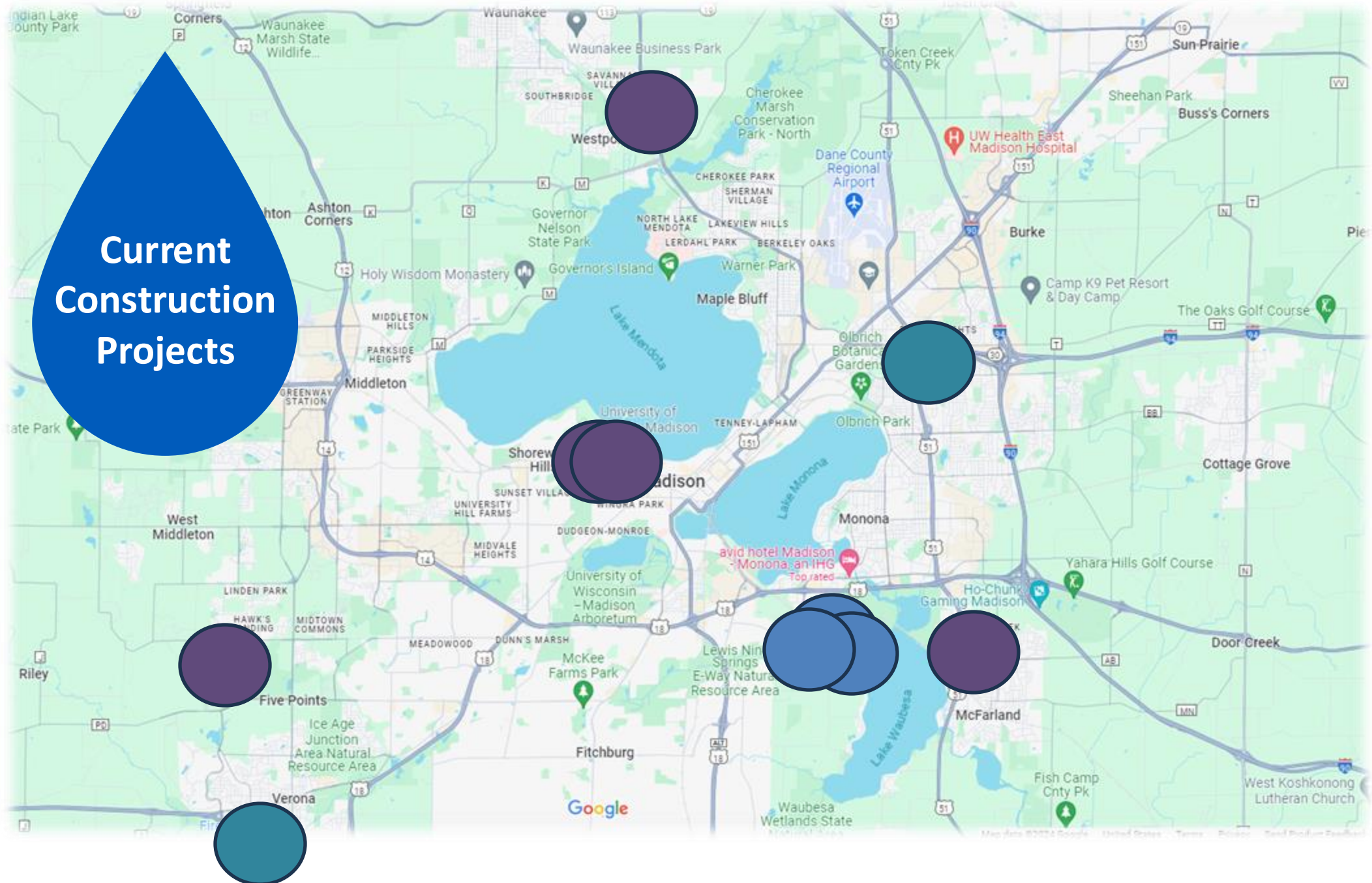

Under construction

Treatment Plant

- Sludge Thickeners 1 and 2 Drive Replacement
- Electrical Service Equipment Replacement
- Flow Splitter Improvements

Interceptors

- Lower Badger Mill Creek Interceptor – Phase 6 C 2025/2026
- West Interceptor Rehab - Segoe Road to Shorewood Boulevard
- NEI – Waunakee Extension Capacity Improvements (Phase 1)
- Southeast Interceptor Rehabilitation on USH 51(Phase 1)
- West Interceptor Shorewood Relief Ph 3

Pumping Stations and Force Mains

- Pumping Station 17 Firm Capacity Improvements
- *Pumping Station 10 Force Main –Bids due 8/5*



Projects completed in 2025 (so far...)

Treatment Plant

2021 Treatment Plant HVAC Improvement Project

Interceptors

Pumping Stations and Force Mains

Pumping Station 17 Force Main Relief Ph 2 -
~substantially complete

Pumping Station 4 Rehabilitation ~substantially complete



2025 Bids (so far...)

West Interceptor Rehab – Segoe Road to Shorewood Blvd

- Bid Cost \$895,000 (Visu-Sewer)

Lower Badger Mill Creek Interceptor – Phase 6

- Bid Cost \$3,445,000 (Integrity)





Project Highlights

Madison Metropolitan Sewerage District



Pumping Station 17 – Planned Service Area

- Anticipated future service area shown in gray
- Mid Town lift station – temporary + reaching capacity
- Current Capacity Limitations being addressed by District projects:
 - LBMCI Connection
 - PS 17
 - PS 17 FM

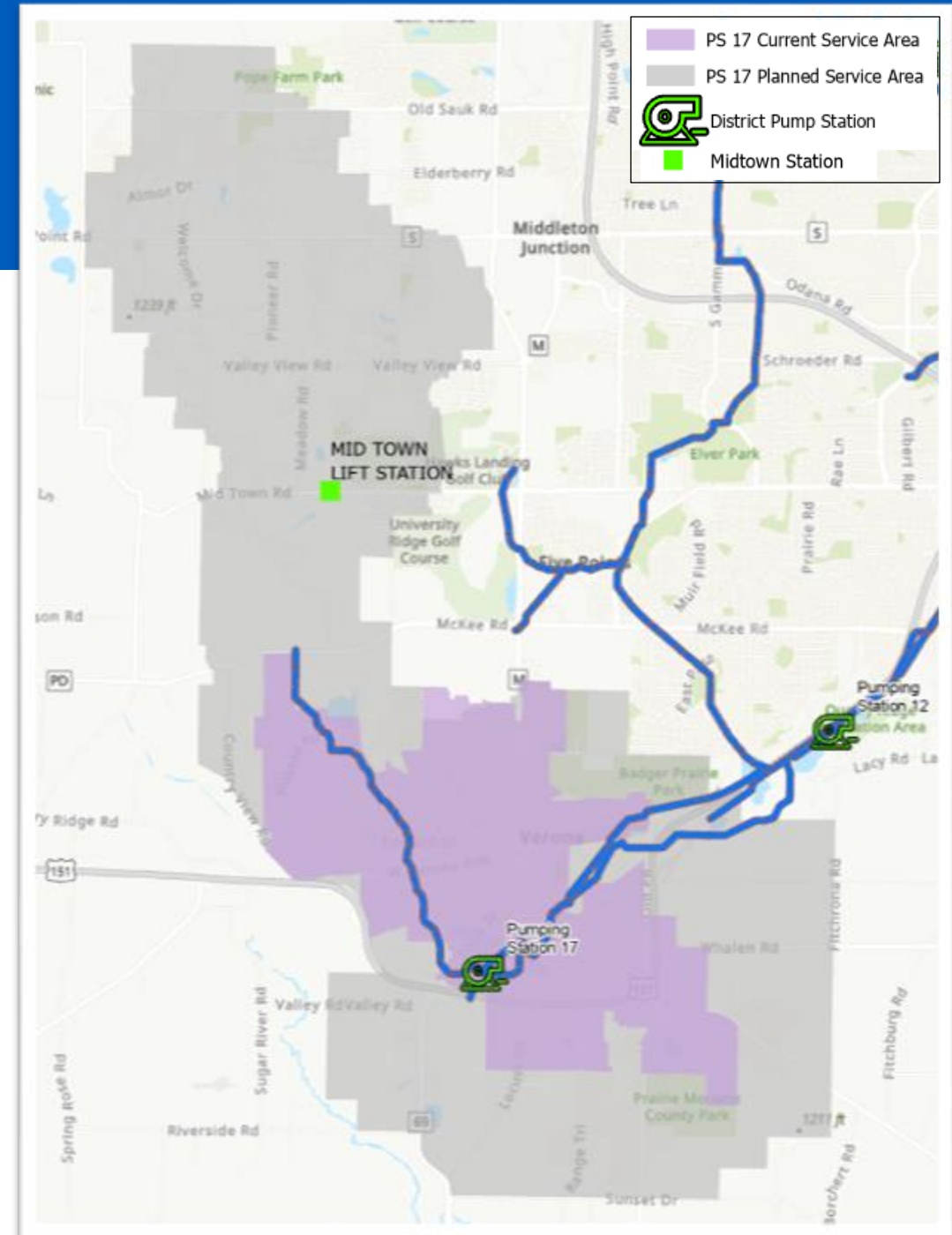

Pumping Station 17 Force Main Relief Phase 2

Scope

8000 ft of 24-inch force main, 3300 ft of interceptor. Tunnel below 151/PB. Partner with City of Verona on paved trail and sewer work with Town of Verona. Connect Phase 1 to Nine Springs Valley Interceptor (to PS 12)

Schedule and Status

- Began construction Fall 2023
- No delays, substantial completion 5/2025
- completing punch list
- Final completion expected 8/2025

Contractor

Minger Construction Co., Inc.

Budget

Total Project Cost: \$12 M

Const contract \$9.9 M

(~\$900K City/Town of Verona)

Madison Metropolitan Sewerage District



Pumping Station 4 Rehabilitation

Scope

Pumps, motor control center, instrumentation and controls, HVAC work, new generator, building and sitework

Schedule and Status

- Began construction Jan 2023
- Substantial completion 6/2025 (Orig 6/2024)
(supply chain delays)
- Final completion expected 8/2025

Contractor

J.F. Ahern Co.

Budget

Total Project Cost: \$7.1M

Construction Contract \$4.2M

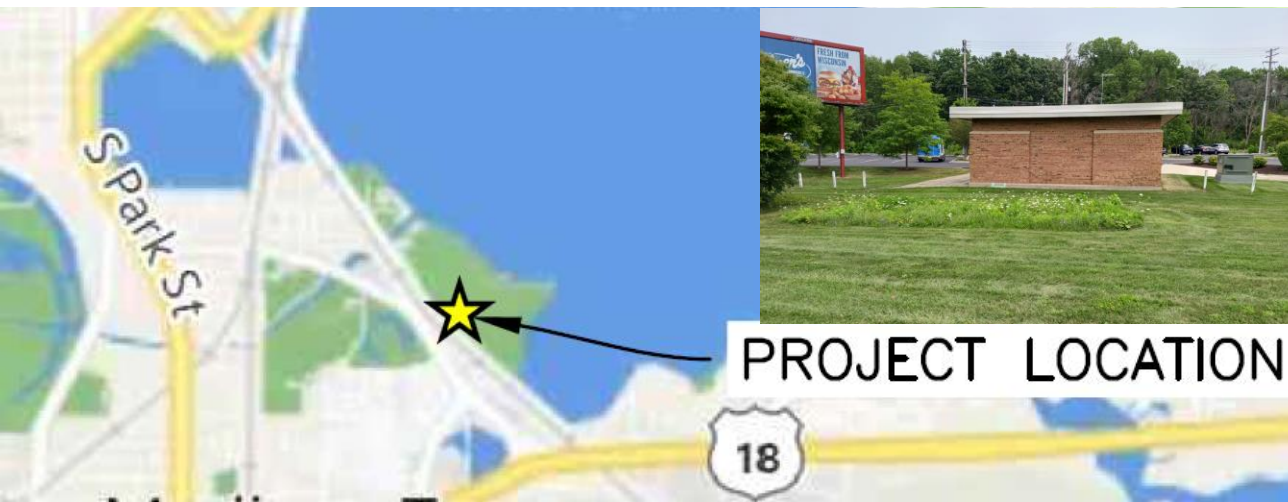



Pumping Station 4 Rehabilitation



Madison Metropolitan Sewerage District



Questions?

Madison Metropolitan
Sewerage District

Madison Metropolitan Sewerage District

Madison Metropolitan Sewerage District