



# Innovative Public Engagement For a One Water Future

1/28/2021 - Catherine Harris, Pollution Prevention Specialist



**One Water Roadmap:**  
The Sustainable Management of  
Life's Most Essential Resource



America's water future  
is at a crossroads... we  
are experiencing  
challenges like we have  
never seen before...

- *US Water Alliance*



# Advancing One Water Through Arts and Culture: A Blueprint for Action



*The complex water challenges we face today cannot be solved solely by the approaches we have used in the past.*

*- US Water Alliance*

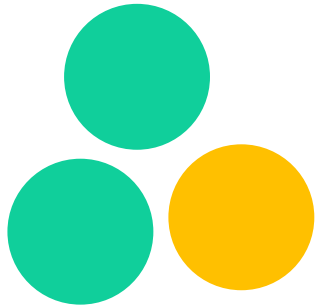

The district is currently relatively unknown by adult residents in the service area. One in three “Have No Opinion or have Never Heard of” the district.

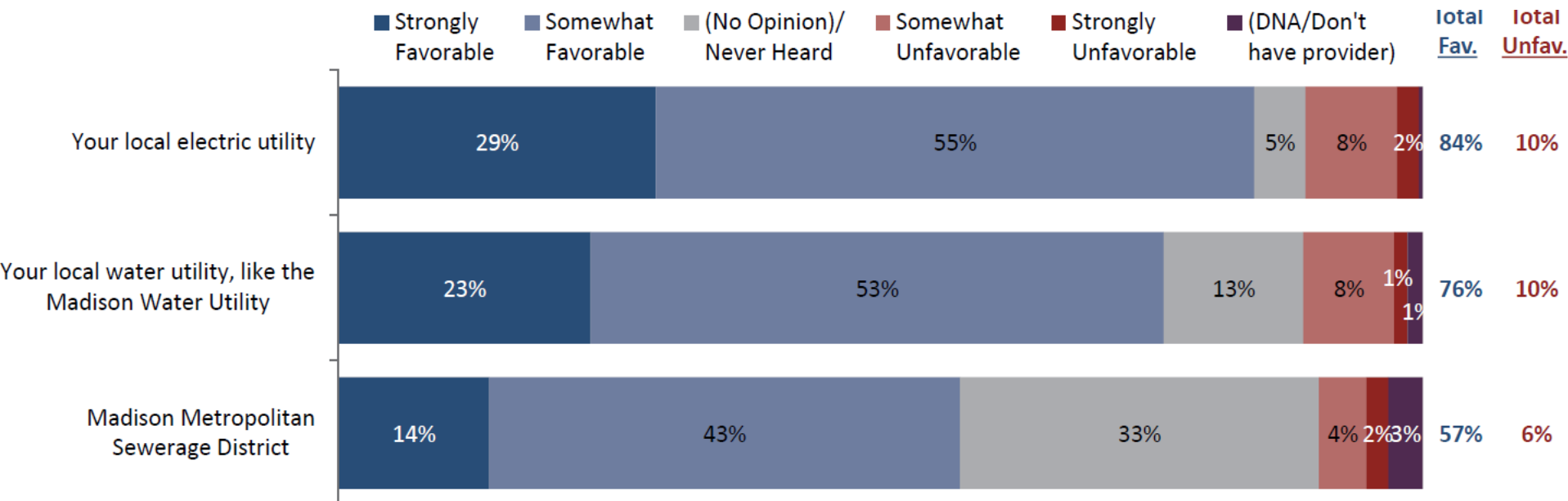



From a random sample of adult, service area residents polled in 2019, majority think the district could do better in educating the community about water.

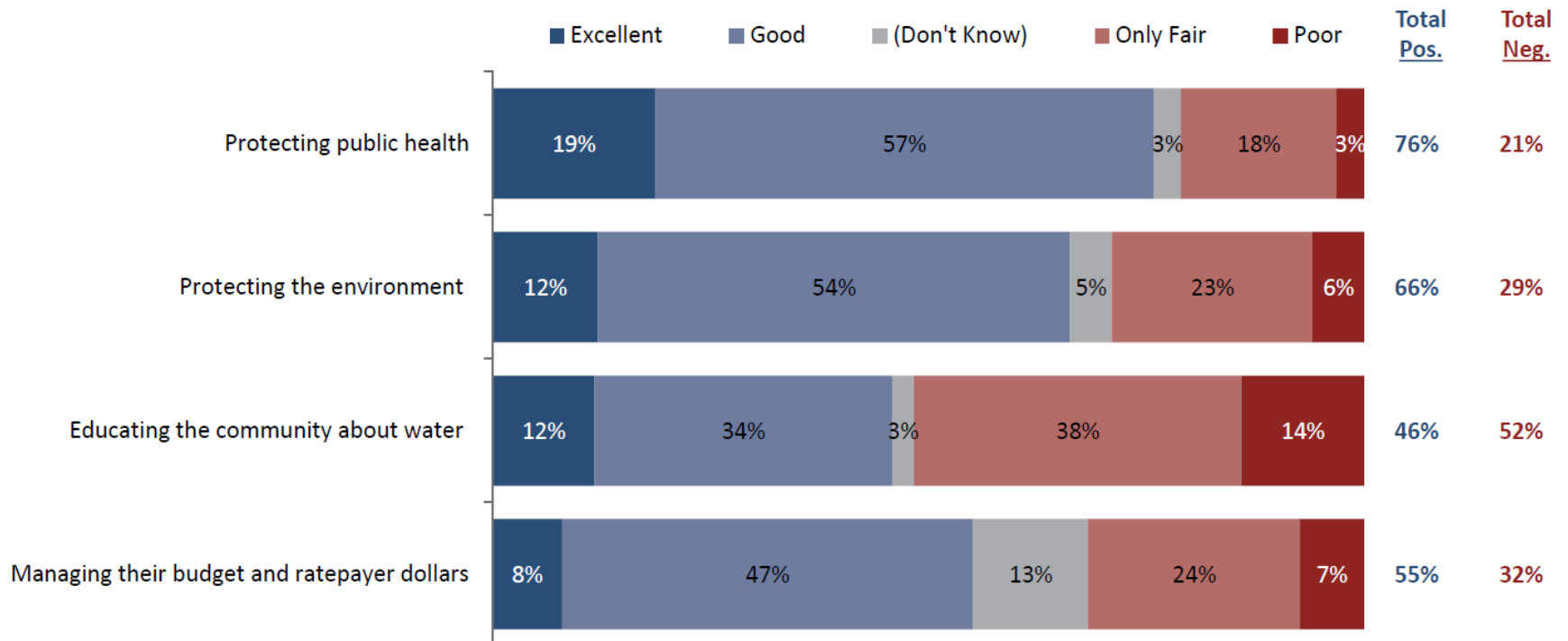

# Wastewater Adventure

Is LOTT in Your Future?  
*Take the Virtual Challenge*

5













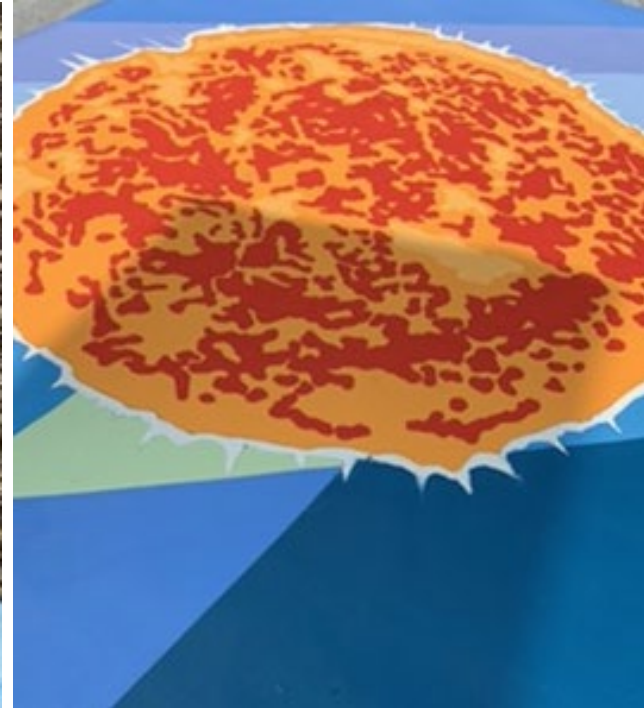
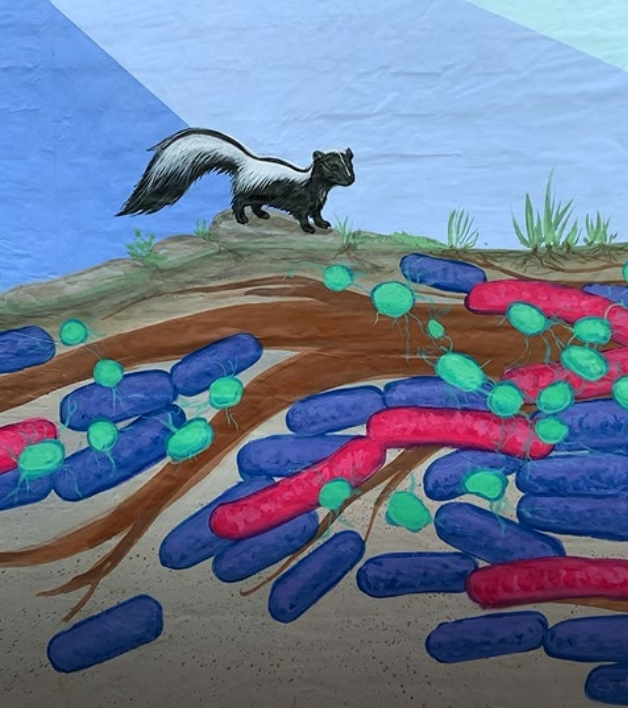



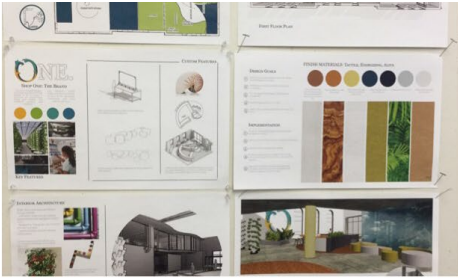

# Imagining Possibilities For Shop One

DS 626 Capstone Gallery Reception  
12/13 - 5pm (open during regular gallery hours through 12/16)

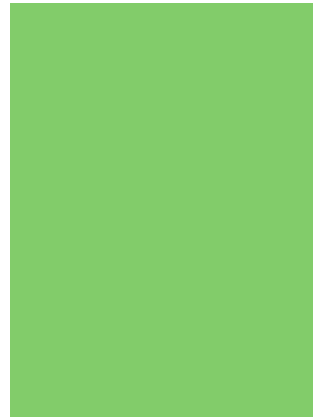
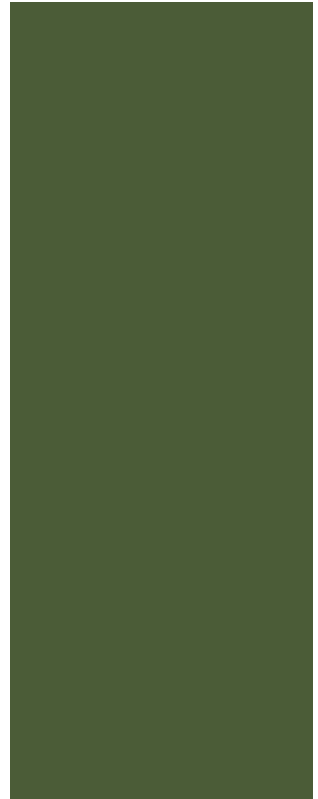



### SHOP ONE

**Visual Requirements**



**Visual Requirements**

The shop layout is designed to be a multi-functional space that can be used for various purposes. It is designed to be a multi-functional space that can be used for various purposes. The layout is designed to be a multi-functional space that can be used for various purposes. The layout is designed to be a multi-functional space that can be used for various purposes.

**Visual Requirements**

The shop layout is designed to be a multi-functional space that can be used for various purposes. It is designed to be a multi-functional space that can be used for various purposes. The layout is designed to be a multi-functional space that can be used for various purposes. The layout is designed to be a multi-functional space that can be used for various purposes.

**Visual Requirements**

The shop layout is designed to be a multi-functional space that can be used for various purposes. It is designed to be a multi-functional space that can be used for various purposes. The layout is designed to be a multi-functional space that can be used for various purposes. The layout is designed to be a multi-functional space that can be used for various purposes.

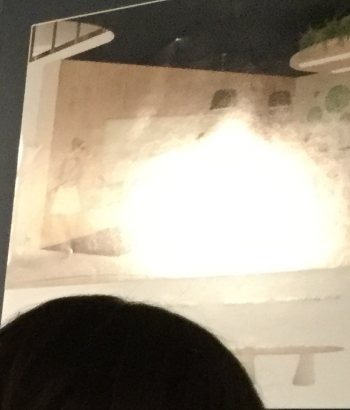
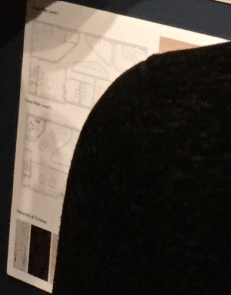



## SITE ANALYSIS

The site is located in a historic building in the heart of the city. The building is a former bank and has been converted into a modern office space. The site is surrounded by historic buildings and is in a prime location for a modern office space.

## PROJECT GOALS

- Showcase sustainable design
- Challenge local norms
- Test new approaches
- Create bonds in community
- Support local business
- Create conversation and interaction
- Convey the message of "one water"
- Showcase water water treatment as a sustainability process
- Create a space that speaks to people's emotions
- Increase public attendance & awareness

## DESIGN FEATURES

### Reception Desk

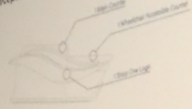

### Custom Lighting Feature

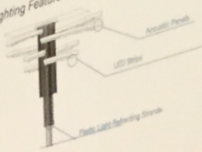

## SPACE PLANNING

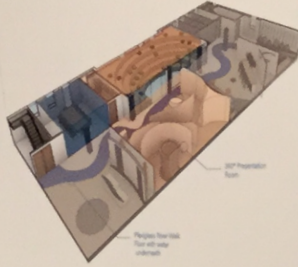
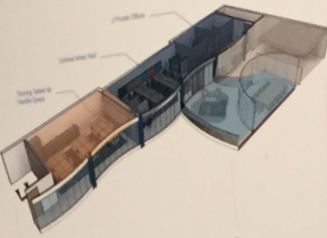

### Diagram Color Key:

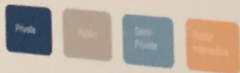

## SPACE PLANNING

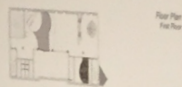
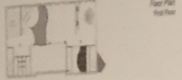

## DESIGN FEATURES

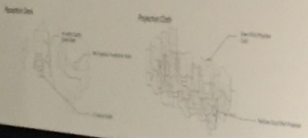

"We are just a drop in the ocean, but we are the entire ocean in a drop."

Run Drop Crystal



# BEFORE & AFTER

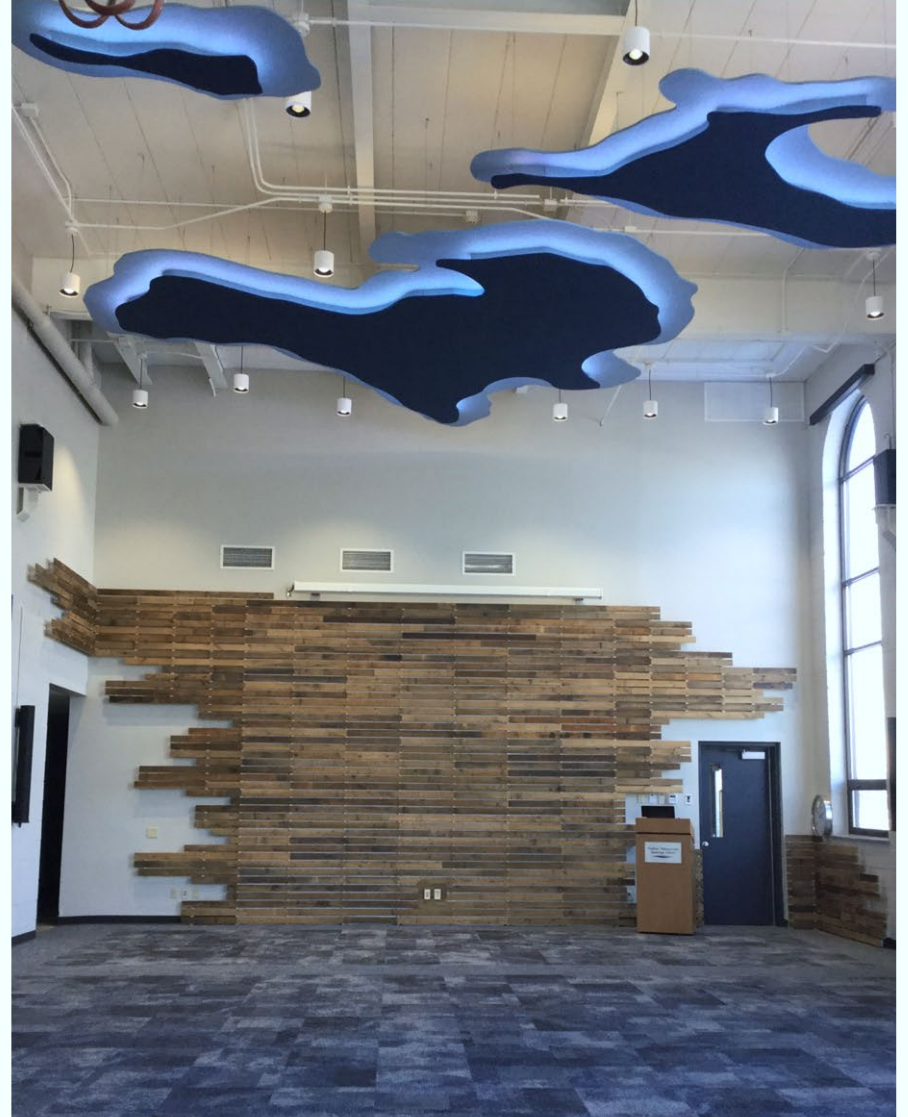





ORLEY MEYER 3858





Shop One







1957







01/29/2016



# Goals of Water Shop

Vision: Flexible space to stimulate water connections

Mission: Engage and empower water stewards

Values:

- *Dynamic environment* that inspires experimentation, creativity, learning and engagement.
- *Flexible platform* to adjust to evolving collective social learning over time.
- *Foster connections* and dialogues
- *Conscious* of rate payer investment
- Support plant tours and other District needs
- *Expand* boundaries
- *Inspire* curiosity
- *Build capacity* as a valued partner in overall community well being

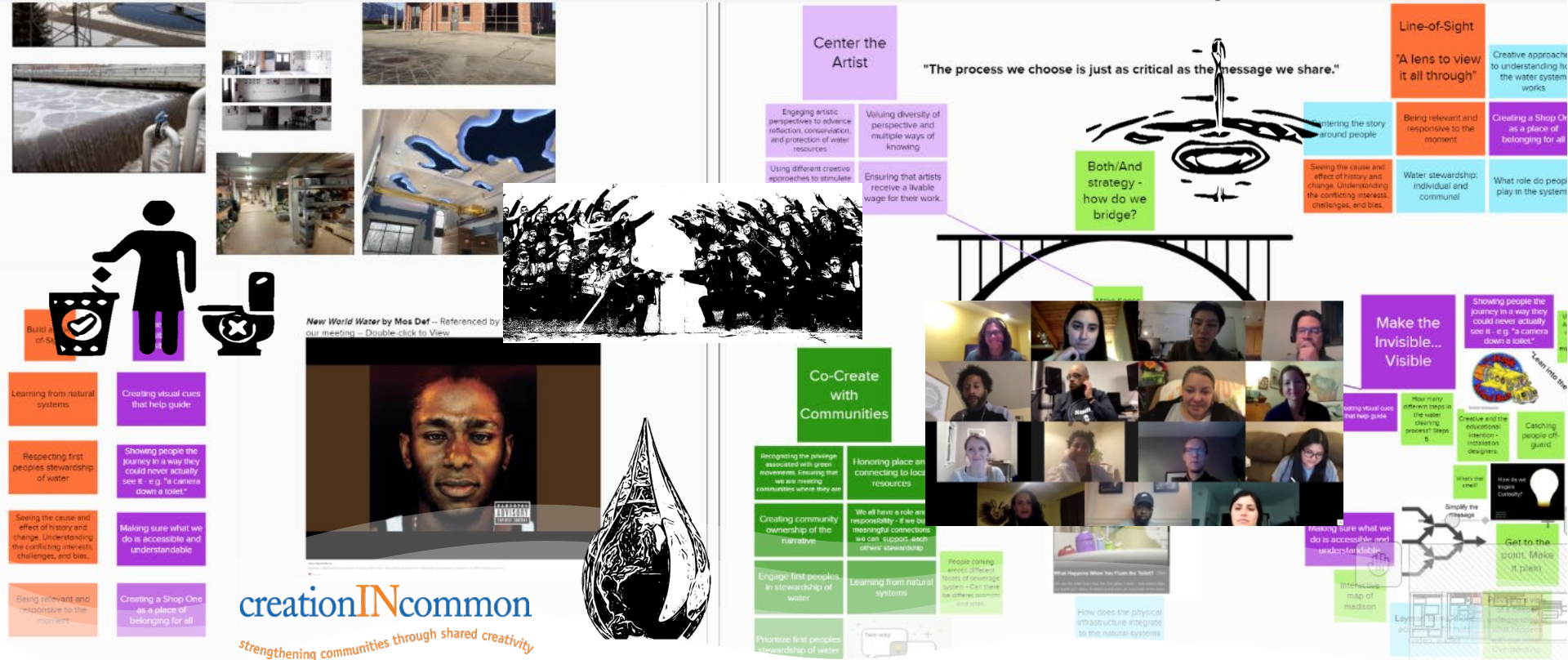

# Catalytic Projects





# SHOP ONE

Stimulating water connections, engaging and empowering water stewards.

<https://onewatermadison.org/>